

High performance end mills for machining dental workpiece materials such as zirconium oxide, titanium alloys, plastics and cobalt/chrome



End mill series for Dental Workpiece Materials

MSTAR* / *CRN* / *DF

Features

1

MSTAR Solid Carbide End Mill Series

PVD-coated end mills for general machining. The innovative coating and cutting edge geometry allows secure and reliable machining of dental workpiece materials such as cobalt/chrome and titanium alloys.

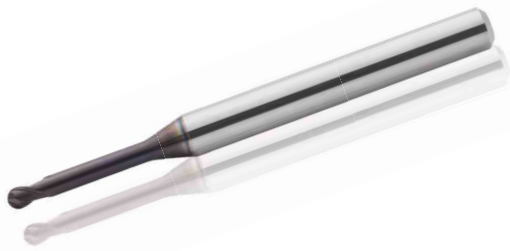

2

CRN Solid Carbide End Mill Series

CRN-coated end mills for general machining of zirconium oxide and plastics. The extremely smooth coating combined with long tool life and high cutting edge sharpness guarantees burr free machining of blanks.

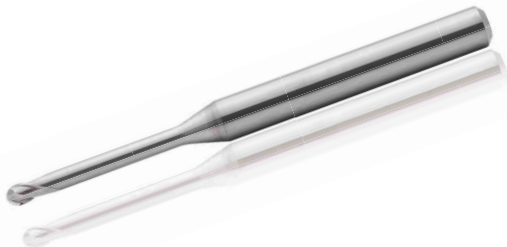

3

DF Solid Carbide End Mill Series

DF-Diamond coated end mills for machining zirconium oxide. The newly developed diamond coating offers long tool life compared to conventionally coated tools.



MSTAR END MILLS

MS2XLB

2 flutes, Ball nose, Long Neck



Effective length for inclined angle

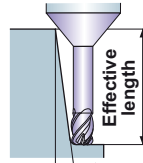

Inclined angle

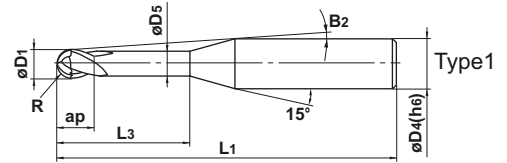

- Ball nose end mill with PVD-coating for cobalt/chrome and titanium alloys

Unit : mm

Order Number	R	D1	ap	L3	D5	B2	L1	D4	N	Stock	Type	Effective length for inclined angle			
												30°	1°	2°	3°
MS2XLBR0100N100	1	2	2	10	1.9	4.5°	50	4	2	●	1	10.4	10.8	11.5	12.4
R0100N100S06	1	2	2	10	1.9	6.9°	50	6	2	●	1	10.4	10.8	11.5	12.4
R0100N120	1	2	2	12	1.9	3.9°	50	4	2	●	1	12.5	12.9	13.8	14.9
R0100N120S06	1	2	2	12	1.9	6.1°	55	6	2	●	1	12.5	12.9	13.8	14.9
R0100N140	1	2	2	14	1.9	3.4°	50	4	2	●	1	14.6	15.1	16.1	17.4
R0100N140S06	1	2	2	14	1.9	5.6°	55	6	2	●	1	14.6	15.1	16.1	17.4
R0100N160	1	2	2	16	1.9	3.1°	55	4	2	●	1	16.7	17.2	18.4	19.9
R0100N160S06	1	2	2	16	1.9	5.1°	60	6	2	●	1	16.7	17.2	18.4	19.9
R0100N180	1	2	2	18	1.9	2.8°	55	4	2	●	1	18.7	19.4	20.7	*
R0100N180S06	1	2	2	18	1.9	4.7°	60	6	2	●	1	18.7	19.4	20.7	22.3
R0100N200	1	2	2	20	1.9	2.5°	60	4	2	●	1	20.8	21.5	23	*
R0100N200S06	1	2	2	20	1.9	4.3°	60	6	2	●	1	20.8	21.5	23	24.8
R0125N100S06	1.25	2.5	2.5	10	2.4	6.5°	50	6	2	●	1	10.4	10.8	11.5	12.3
R0125N125S06	1.25	2.5	2.5	12.5	2.4	5.6°	50	6	2	●	1	13	13.5	14.4	15.4
R0125N160S06	1.25	2.5	2.5	16	2.4	4.7°	60	6	2	●	1	16.7	17.2	18.4	19.8
R0125N200S06	1.25	2.5	2.5	20	2.4	4°	60	6	2	●	1	20.8	21.5	23	24.8
R0150N100	1.5	3	3	10	2.9	6°	60	6	2	●	1	10.4	10.8	11.5	12.3
R0150N120	1.5	3	3	12	2.9	5.3°	60	6	2	●	1	12.5	12.9	13.8	14.8
R0150N140	1.5	3	3	14	2.9	4.7°	60	6	2	●	1	14.6	15	16.1	17.3
R0150N160	1.5	3	3	16	2.9	4.3°	60	6	2	●	1	16.6	17.2	18.4	19.7
R0150N200	1.5	3	3	20	2.9	3.6°	70	6	2	●	1	20.8	21.5	23	24.7

* No interference

● : Inventory maintained.

CRN END MILLS

CRN2XLB

2 flutes, Ball nose, Long Neck



Effective length for inclined angle

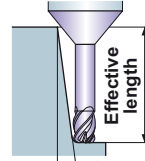

Inclined angle

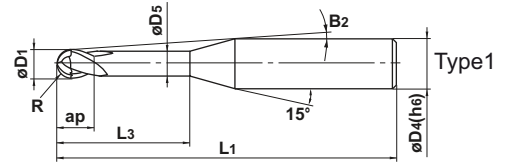

- Ball nose end mill with CrN-coating for zirconium oxide and plastics

Unit : mm

Order Number	R	D1	ap	L3	D5	B2	L1	D4	N	Stock	Type	Effective length for inclined angle			
												30°	1°	2°	3°
CRN2XLB R0050N100S04	0.5	1	1	10	0.94	5.6°	50	4	2	●	1	10.5	10.9	11.7	12.6
R0050N100S06	0.5	1	1	10	0.94	7.5°	50	6	2	●	1	10.5	10.9	11.7	12.6
R0050N120S04	0.5	1	1	12	0.94	5°	50	4	2	●	1	12.6	13.1	14	15.1
R0050N120S06	0.5	1	1	12	0.94	6.8°	50	6	2	●	1	12.6	13.1	14	15.1
R0050N140S04	0.5	1	1	14	0.94	4.5°	50	4	2	●	1	14.7	15.2	16.3	17.6
R0050N140S06	0.5	1	1	14	0.94	6.2°	55	6	2	●	1	14.7	15.2	16.3	17.6
R0050N160S04	0.5	1	1	16	0.94	4.1°	55	4	2	●	1	16.8	17.4	18.6	20.1
R0050N160S06	0.5	1	1	16	0.94	5.7°	55	6	2	●	1	16.8	17.4	18.6	20.1
R0100N100S04	1	2	2	10	1.90	4.5°	50	4	2	●	1	18.8	19.5	20.9	22.5
R0100N100S06	1	2	2	10	1.90	6.9°	50	6	2	●	1	18.8	19.5	20.9	22.5
R0100N120S04	1	2	2	12	1.90	3.9°	50	4	2	●	1	20.9	21.6	23.2	*
R0100N120S06	1	2	2	12	1.90	6.1°	50	6	2	●	1	20.9	21.6	23.2	25
R0100N140S04	1	2	2	14	1.90	3.4°	50	4	2	●	1	8.3	8.7	9.2	9.9
R0100N140S06	1	2	2	14	1.90	5.6°	55	6	2	●	1	8.3	8.7	9.2	9.9
R0100N160S04	1	2	2	16	1.90	3.1°	55	4	2	●	1	10.4	10.8	11.5	12.4
R0100N160S06	1	2	2	16	1.90	5.1°	55	6	2	●	1	10.4	10.8	11.5	12.4
R0100N200S04	1	2	2	20	1.90	2.5°	60	4	2	●	1	12.5	12.9	13.8	14.9
R0100N200S06	1	2	2	20	1.90	4.3°	60	6	2	●	1	12.5	12.9	13.8	14.9
R0150N160S06	1.5	3	3	16	2.90	4.3°	60	6	2	●	1	16.7	17.2	18.4	19.9
R0150N250S06	1.5	3	3	25	2.90	3°	70	6	2	●	1	16.7	17.2	18.4	19.9

* No interference

● : Inventory maintained.

DF END MILLS

DF2XLB

2 flutes, Ball nose, Long Neck



Effective length for inclined angle

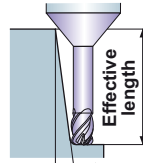

Inclined angle

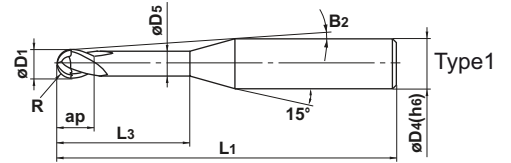

- Ball nose end mill with CVD DF-Diamond coating for zirconium.

Unit : mm

Order Number	R	D1	ap	L3	D5	B2	L1	D4	N	Stock	Type	Effective length for inclined angle			
												30°	1°	2°	3°
DF2XLBR0050N100	0.5	1	1.5	10	0.94	5.2°	60	4	2	●	1	10.5	11	12	13.3
R0050N120	0.5	1	1.5	12	0.94	4.6°	60	4	2	●	1	12.6	13.2	14.4	15.9
R0050N200	0.5	1	1.5	20	0.94	3.3°	80	4	2	●	1	21	21.9	24	26.6
R0100N100	1	2	3	10	1.9	4.2°	60	4	2	●	1	10.4	10.9	11.8	13
R0100N120	1	2	3	12	1.9	3.7°	60	4	2	●	1	12.5	13	14.2	15.7
R0100N160	1	2	3	16	1.9	2.9°	80	4	2	●	1	16.7	17.4	19	*
R0100N200	1	2	3	20	1.9	2.5°	80	4	2	●	1	20.9	21.8	23.8	*
R0150N160	1.5	3	4.5	16	2.9	1.7°	80	4	2	●	1	16.7	17.3	*	*
R0150N250	1.5	3	4.5	25	2.9	1.2°	80	4	2	●	1	26.1	27.2	*	*

* No interference

● : Inventory maintained.



MITSUBISHI
MITSUBISHI MATERIALS

www.mitsubishicarbide.com

MMC HARTMETALL GmbH

Comeniusstr. 2, 40670 Meerbusch Germany
Tel. +49-2159-91890 Fax +49-2159-918966
e-mail admin@mmch.de

MMC HARDMETAL U.K. LTD.

Mitsubishi House, Galena Close, Amington Heights, Tamworth. B77 4AS, U.K.
Tel. +44-1827-312312 Fax +44-1827-312314
e-mail sales@mitsubishicarbide.co.uk

MMC METAL FRANCE S.A.R.L.

6, rue Jacques Monod, 91400 Orsay, France
Tel. +33-1-69-35-53-53 Fax +33-1-69-35-53-50
e-mail mmf-sales@mmc-metal-france.fr

MITSUBISHI MATERIALS ESPAÑA, S.A.

Calle Emperador 2, 46136 Museros, Valencia, Spain
Tel. +34-96-144-1711 Fax +34-96-144-3786
e-mail mme@mmevalencia.com

MMC ITALIA S.R.L.

Viale delle Industrie 2, 20020 Arese (Mi) Italy
Tel. +39-02-93-77-03-1 Fax +39-02-93-58-90-93
e-mail info@mmc-italia.it

MMC HARDMETAL POLAND SP. z o.o.

Al. Armii Krajowej 61, 40-541 Wrocław, Poland
Tel. +48-71-335-16-20 Fax +48-71-335-16-21
e-mail sales@mitsubishicarbide.com.pl

MMC HARDMETAL OOO LTD.

ul. Bolschaya Semenovskaya 11, bld. 5, 107023 Moscow, Russia
Tel. +7-495-72558-85 Fax +7-495-98139-73
e-mail mmc@carbide.ru